

**GENERAL NOTES:**  
 This drawing must not be copied in whole or in part without prior written permission of Riva Architects Limited. This drawing must be read in conjunction with other architects drawings & all schedules (Building Bye-Law check list and with all relevant structural engineering drawings, details and specifications. It is the contractor's responsibility to ensure that all work is carried out in accordance with all statutory requirements and to the approval of the building control officer (B.C.O.). The contractor is responsible for the setting out of the works. Any discrepancy found between this drawing and any other architect's detail drawing, schedule and/or specification must be reported to the architect before the work is carried out. Do not scale from this drawing. Refer only to written dimensions. All dimensions must be checked on site. The relevant British Standards for materials and their uses are to be adhered to. Manufacturers installation & fitting instructions must be obtained and adhered to at all times.

**KEY**

- H Heat Detection Alarm
- S Smoke Detection Alarm
- CO Carbon Monoxide Alarm
- D-01 Window / door / roof light reference
- ← Travel Distance
- Proposed Rainwater drainage
- Compartment Wall/Floor
- Foul water Drainage
- Protected entrance hall (30 min. Fire Rating Enclosure)
- Protected corridor (60 min. Fire Rating Enclosure)
- FD30S Fire Rated (30 min.) self closing door with intuscent strips
- FD60S Fire Rated (60 min.) self closing door with intuscent strips
- EX. VENT Mechanical Extractor
- SVP Soil & Vent Pipe

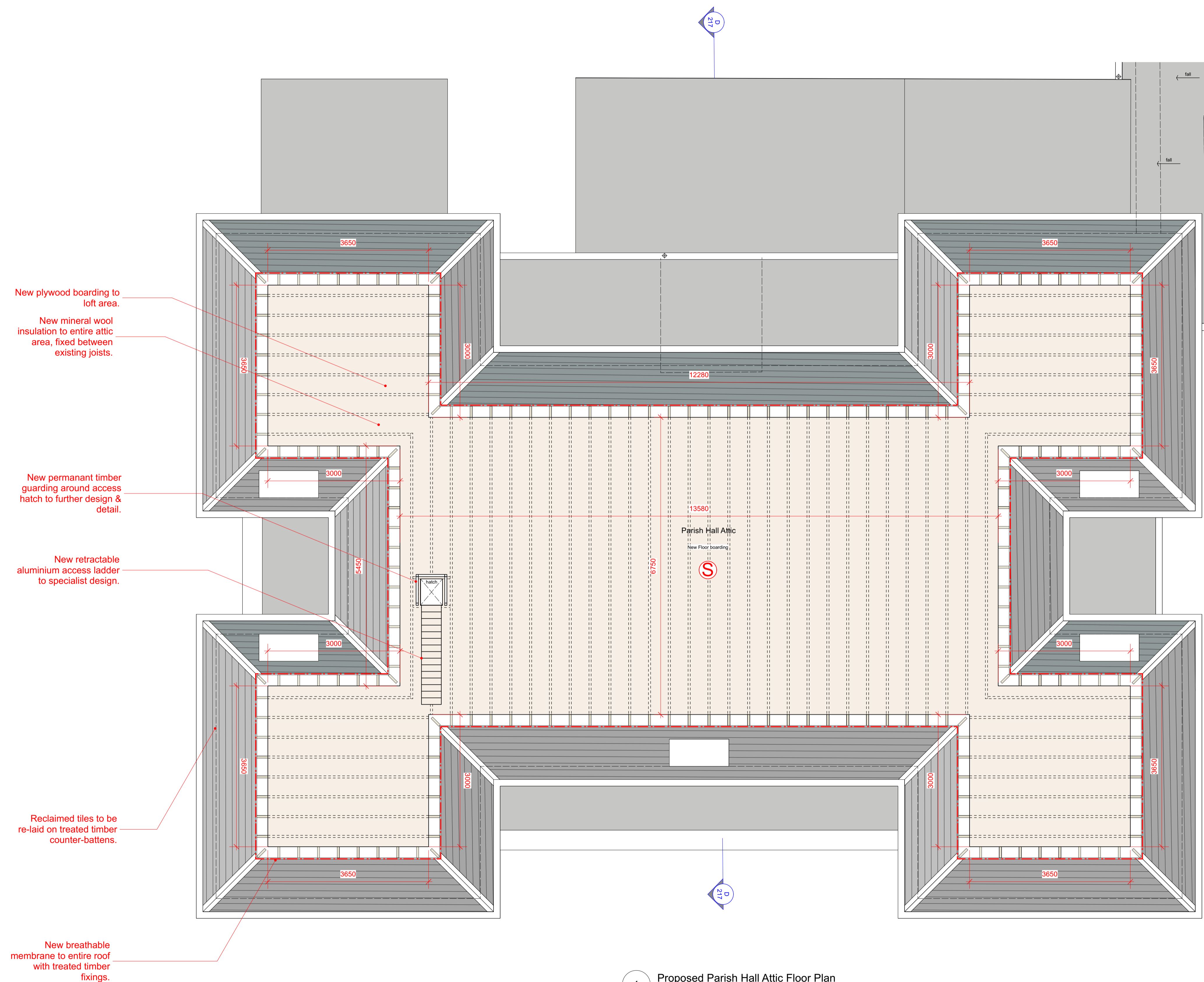

New plywood boarding to loft area.  
 New mineral wool insulation to entire attic area, fixed between existing joists.

New permanent timber guarding around access hatch to further design & detail.

New retractable aluminium access ladder to specialist design.

Reclaimed tiles to be re-laid on treated timber counter-battens.

New breathable membrane to entire roof with treated timber fixings.

1 Proposed Parish Hall Attic Floor Plan  
 Scale: 1:50

REV	DESCRIPTION	DATE

JOB TITLE  
**Proposed Loft Conversion to**  
**The St. Brelade's Parish Hall**  
 La Neuve Route, St. Brelade JE3 8BS  
 The Parish of St. Brelade

DRAWING TITLE  
**TENDER**  
 PROPOSED  
**PARISH HALL ATTIC PLAN**

DATE	SCALE
Sections CC & DD	1:50 @ A1

JOB NO.	DRG NO.	REVISION	DRAWN
1009	232	-	MH

T +44 (0) 1534 499383  
 F +44 (0) 1534 499338  
 E office@riva-architects.com  
 W www.riva-architects.com

1ST FLOOR, INDUSTRIA HOUSE,  
 RED HOUSES, ST. BRELADE,  
 JERSEY, JE3 8LD.

**RIVA ARCHITECTS** eco member business